

# Mounting Instructions

# SUPREME 1™

1. Mount the plastic panel strip to the rear of the graphic panel by removing the pink protective covering on the double sided tape a few inches at a time.

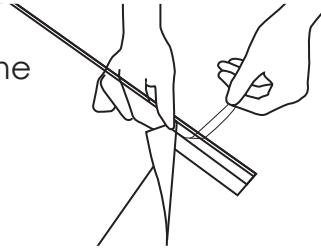

2. Press the graphic firmly against the panel strip to ensure good adhesion to the tape.

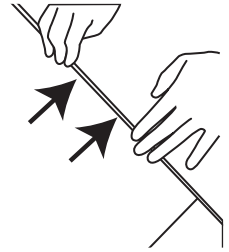

3. Repeat steps 1 and 2 with the yellow protective covering.

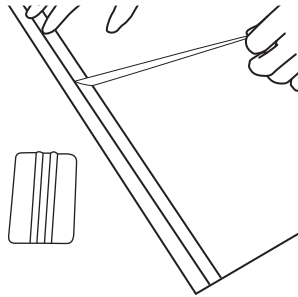

4. Repeat steps 1 to 3 for the bottom of the graphic.

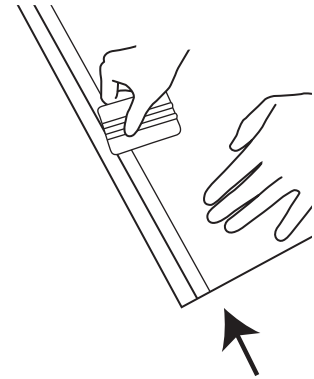

\*\*\*For additional protection, secure the plastic panel strip to the rear of the panel with an extra strip of tape.\*\*\*

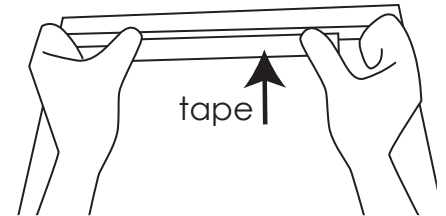

5. Slide the top plastic panel strip (top of graphic) into the metal top profile bar and secure with a piece of tape.

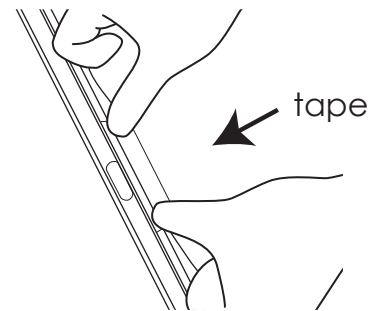
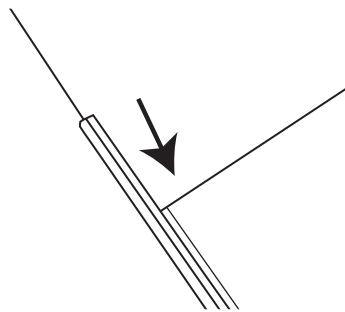

6. Open the cover by pressing the blue buttons at either end of the base unit, and remove the internal roller.

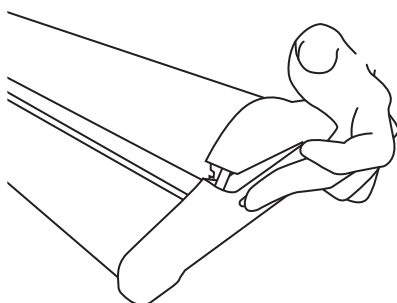

7. Slide the bottom panel strip into the slot on the roller.

Slide the bottom panel strip into the slot on the roller.

continued...

# Mounting Instructions

**SUPREME 1™**

8. Roll the entire graphic around the internal roller and place it into the base unit. Ensure the roller is properly mounted into the base unit and close the cover.

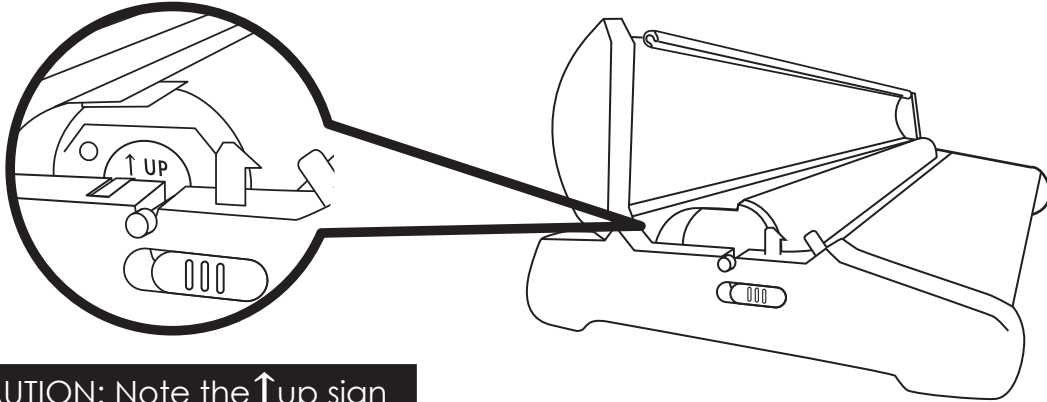

**CAUTION:** Note the ↑up sign

9. Remove the locking pin and set up your Supreme 1 by following the Set Up Instructions.

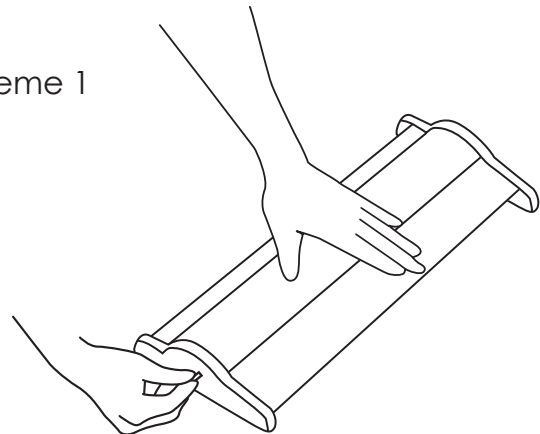

## Changing Graphics

- a. Pull the graphic out slightly.

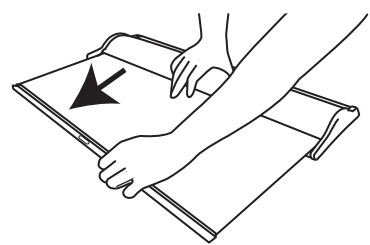

- b. Insert the locking pin into the right end plate completely. Once locked, the panel will not retract into the base unit.



- c. Press the buttons at either end of the base unit to open the cover.

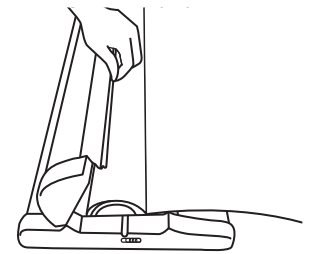

- d. Unroll the remainder of the graphic and slide the panel strip out from the internal roller.

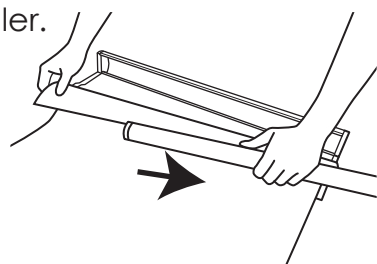

- e. Follow the directions to mount a new graphic.